

Line Diagram of Boring & Lowering of T/W

Actual lowering of T/W at Amlikaur Project T/W no. 01
Gauri Kalan(Kumhariyadera) Village OHT Campus, Jaspura Block, Banda

| | | |
|---|----|--------------------------------------|
| Date of Start | :- | 22-10-2021 |
| Dia. Of Bore | :- | 500 MM |
| Total Lowered 200mm Dia M.S. Plain Pipe | :- | 66 Mtr. |
| Total Lowered 150mm Dia M.S. Plain Pipe | :- | 06 Mtr. |
| Total Lowered 200mm Dia M.S. Slotted Pipe | :- | 18 Mtr. |
| Total Lowered 150mm Dia M.S. Slotted Pipe | :- | 0 Mtr. |
| Total lowered Tube well Assembly | :- | 91.5 Mtr. Including reducer(200*150) |
| Date of Lowering | :- | 26-10-2021 |

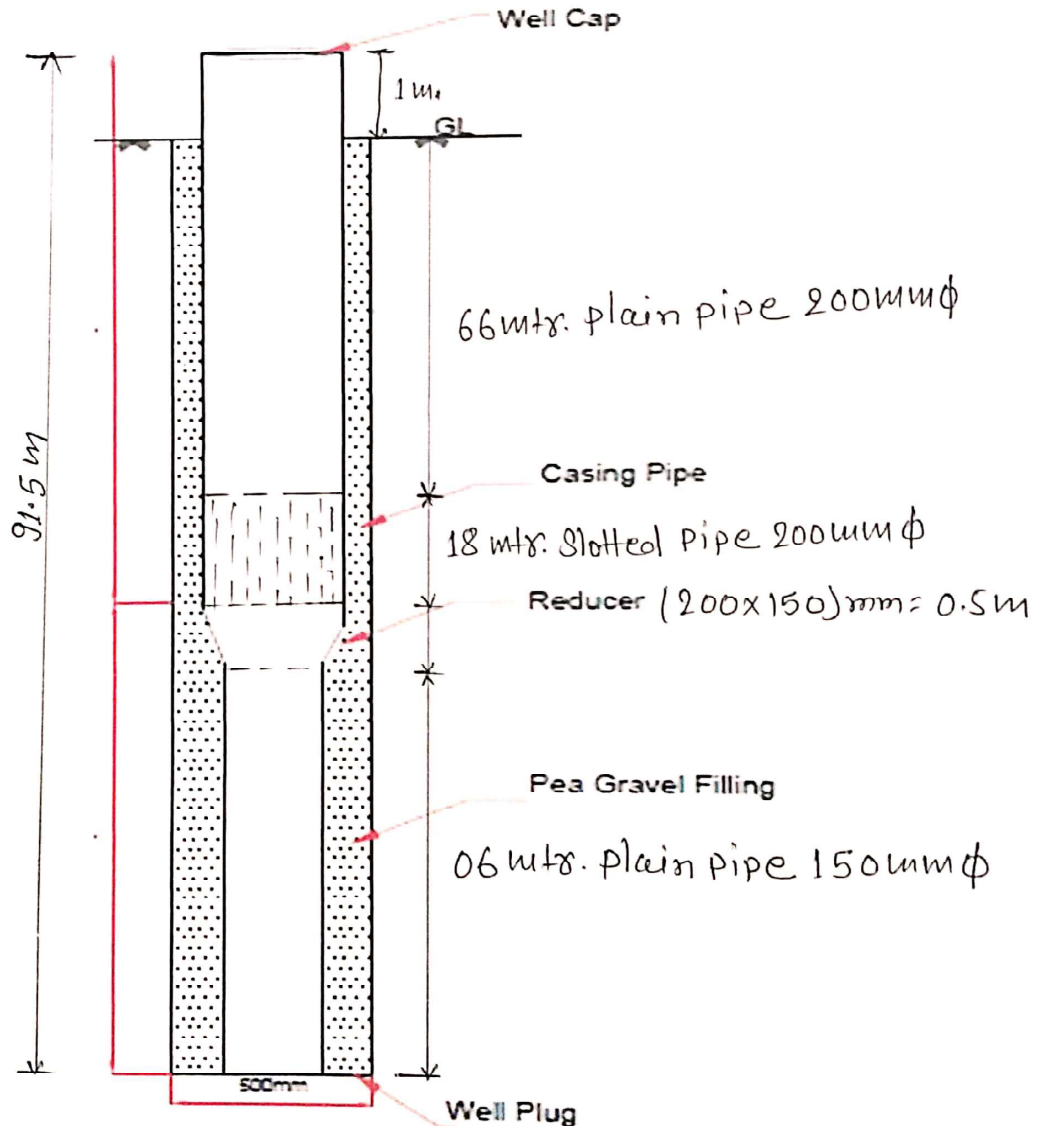

[Signature]
Assistant Project Engineer

Project Engineer

Project Manager