

REPORT ON GEOPHYSICAL WELL LOGGING AT

GRAM PANCHAYAT- BYAUHARA, BLOCK- IGLAS, DISTT- ALIGARH UNDER JAL JIVAN MISSION

Introduction :

A Deep bore hole was drilled 110 mtrs. depth. and Logged depth ~~110~~ mtrs. at above site. Was drilled by M/S Kalpataru Power Transmission limited, Aligarh.

On the request of M/S Kalpataru Power Transmission limited, Aligarh, a Geophysical well Logging is conduct at above bore hole using IGIS Well Logger on 13.Jun.2023.

Logging Para meters - Self potential, short normal (N-16), Long Normal (N-64), Lateral. Details of major aquifer formations explored from logging of bore hole combined with the study of Strata Chart prepared from drill cuttings are given in the following table:-

Mud Resistivity = ~~14.93~~ Ohms.

Drilling Water Resistivity = ~~15.62~~ Ohms.

Approx Water Level = 6 Mtr.

S.No.	Depth range(m)	Thickness(m)	Lithology	Expected Water Quality
1.	0 - 5	5	Surface soil	
2.	5 - 7	2	Clay kankar	
3.	7 - 14	7	Fine sand	
4.	14 - 16	2	Clay kankar	
5.	16 - 23*	7	Fine to Medium sand	Medium
6.	23 - 31	8	Clay kankar	
7.	31 - 37*	6	Fine to Medium sand	Medium
8.	37 - 48	11	Clay kankar	
9.	48 - 53	5	Fine to Medium sand	Marginally saline
10.	53 - 110	57	Clay kankar	

GSh
15/06/23



- Logging performed as per SWSM guidelines
- Groundwater quality interpreted by firm as per their logger calibration.



KALPA-TARU

KALPATARU POWER TRANSMISSION LIMITED

arvee associates
architects engineers & consultants pvt. ltd.



PIPE ASSEMBLY AND LOWERING CHART FOR TUBE WELL

District:- Aligarh Block:- **IGCAS** Scheme:- **BYOHARA**

Rig No/ Type DC:- Size of Bore:-

Under:- **JJM** Assembly Size:- **200x200** Required LPM:- **560**

Contractor:- **KPTL**

CHART		PIPE LENGTH	ASSEMBLY DETAILS
AGL		Pipe No. =	Drilling Started Date:- 08/06/23 DPR Drilling Depth:- 110 M
		Pipe No. =	Logging Started Date:- 13/06/23 Logging Completed Date:- 13/06/23
		Pipe No. =	Lowering Started Date :- 16/06/23 Lowering Completed Date :- 16/6/23
		Pipe No. =	Housing Pipe Φ :- MM M Above AGL Φ :- MM M
		Pipe No. =	Plain Pipe Φ :- 200 MM 30.050 M Slotted Pipe Φ :- 200 MM 13 M
		Pipe No. =	Lowered Assembly:- 43 M Total Assembly+ AGL :- 43+0.5 M
		Pipe No. =	Actual Drilling Depth:- 110 M M MS H Frame:- 1 nos 300mm
		Pipe No. =	MS Ring:- 08 nos 200mm MS Reducer:-
		Pipe No. =	MS Bail Plug:- 01 MS Clamp:- 01
		Pipe No. =	MS Well Cap:- 01 Centre Guide:- 02
		Pipe No. =	
		Pipe No. =	
		Pipe No. = 09 = 6.0 M	
		Pipe No. = 08 = 6.0 M	
		Pipe No. = 07 = 4.50 M	
	0.50 11.111	Pipe No. = 06 = 6.0 M	
slotted	16.0	Pipe No. = 05 = 01.0 M	
slotted	23.0	Pipe No. = 04 = 6.0 M	
		Pipe No. = 03 = 2.0 M	
	31.0	Pipe No. = 02 = 6.0 M	
Slotted	37.0	Pipe No. = 01 = 6.00 M	
Bail Plug	43.0		

Ravindra
Contractor
Representative

Sherman
TPI
Representative

Client
Representative



arvee associates
architects engineers & consultants pvt. ltd.



PROJECT - STATE WATER AND SANITATION MISSION PROJECT ALIGARH

REQUEST FOR INSPECTION (RFI)

Format No : JJM/ALIGARH/KPTL/01

RFI no: JJM/ALIGARH/KPTL/

Date : 16/06/23

Contractor Name: Kalpataru Power Transmission Limited.

LOA No- 3155/W-25 (Aligarh)/2021-22 dated 01.11.2022

Location of Work

DISTRICT: ALIGARH BLOCK: 16/LAS SCHEME: BYAGHARA

Following civil items are ready for inspection :

Date :

SBC Tube Well Excavation PCC RCC
 Drilling Logging Lowering OP Unit Column
 Shuttering Brick Work Plaster Work Painting Stand Post
 Rising Main Backfilling M.S. Wicket Gate/ Window Interlocking Tile
 HDPE Pipeline Others

Following Mechanical, Electrical, C&I items are ready for inspection :

Date :

Instrumentation Welding Valves Chain Pully DG Set
 Pump Set Stabilizer Pannel Sloar Chlorinating Plant
 Lighting EMF Meter Level / Pressure Transmitter RTU
 Earthing cable Starter Piping- DI () HDPE () MS () MDPE () Others

Work Description :

Tube well lowering work Drill depth 110
 CPM - 560 Assembly \Rightarrow 200 x 200 ϕ mm

On Date : 16/06/23

Time : 10:00AM

Submitted By : RAMANAND

Date:

Time 10.00 AM

Sign

TPI (Arvee)

Anan

Received By

Date

Time

Sign

Comments :

Civil Department

E&M, IC Department

NAME :

APPROVED

NAME :

APPROVED

DESIG :

APPROVED AS NOTED

DESIG :

APPROVED AS NOTED

SIGN:

REJECTED

SIGN:

REJECTED

G.P. - BYOHARA, BLOCK - JGLAS, Dist - Aligarh
 Required LPM - 560 LPM

DPR

$$\frac{76}{24} = 100$$

Starts

16-23 \rightarrow 7 mtr

31-37 \rightarrow 6 mtr

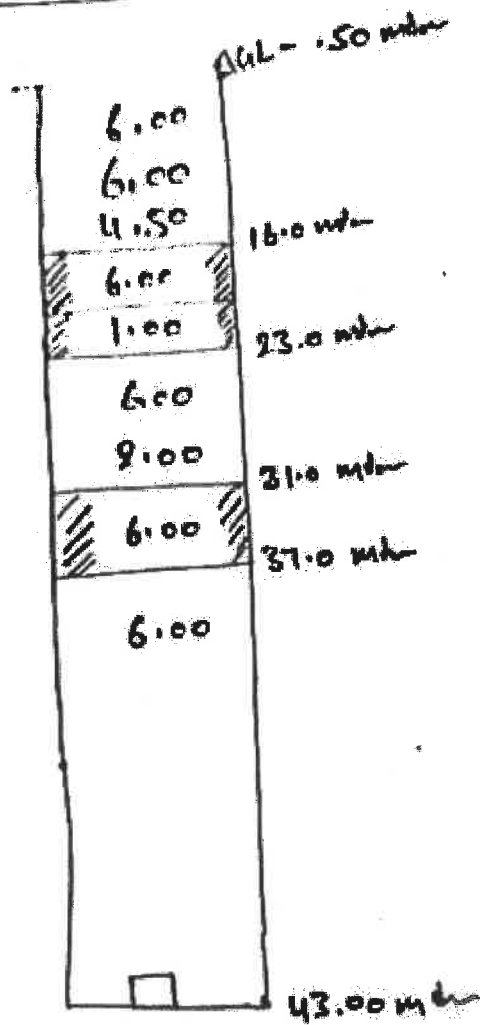

200 mm dia Plain Pipe \rightarrow 30.50 mtr

200 mm dia Slotted Pipe \rightarrow 13.00 mtr

Total 43.50 mtr

AGL (-) 1.50 mtr

BGL 43.00 mtr

Note \rightarrow cement sealing करानी होगी